

修訂	序	修訂	內容	日期
1				
2				
3				

UNIT: mm.

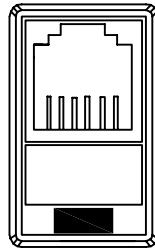

U.S 6P6C SOCKET(1)

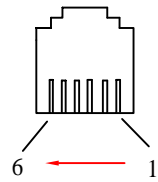
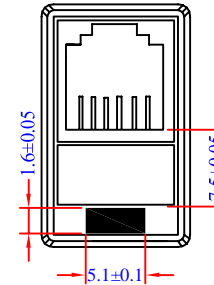
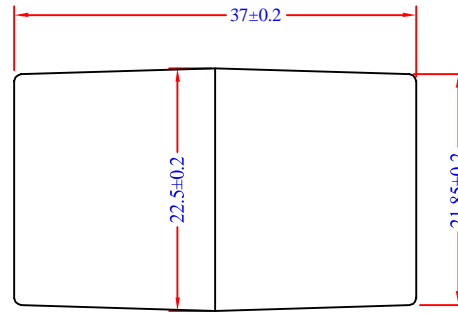
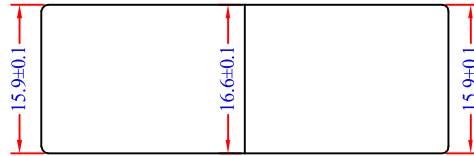

U.S 6P6C SOCKET(2)

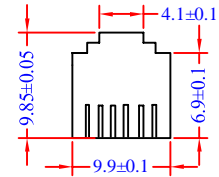

WIRING(1:6)

U.S 6P6C SOCKET(1)

U.S 6P6C SOCKET(2)

1	-----	1
2	-----	2
3	-----	3
4	-----	4
5	-----	5
6	-----	6

1. Housing: ABS UL94V-2, White
2. Contact: Phos Bronze Gold Plated 3u"
3. HOOK-UPWIRE
 - 1) UL1061 26AWG 0.16mm/7 Stranded Tinned Copper*6PCS
 - 2) (SR-PVC)Insulation, ID: 1.0±0.05mm, Color: White, Black, Red, Green, Yellow, Blue
4. PACKING
 - 1) 1 Pc/PolyBag, 10Pcs/Big PE Bag

客 戶 CUSTOMER	ITEM NO.	22 2127	VELOCITY	DATE	DRAWING NO.	APPROVED BY	CHECKED BY	DRAWN BY
	品名 TITLE	210 JACK (U.S 6P6C)WH			LY20000404-011			WQF
					版 次 REVISION	A -- 1		